

PUREFLO® D50C FILTER DISCS

arranged.



PureFlo® D50C Filter Discs have been designed for simple, quick, and efficient filtration of fluids used in laboratory, pilot, and low flow rate applications. 10 different media options can be placed in an all polypropylene construction for excellent chemical compatibility. There are 12 different fitting options that can be mixed and matched for the inlet and outlet fittings. The small compact design of the filter disc reduces hold-up volume. No adhesives or binders are used in the encapsulation process. The disc is thermally-sealed to ensure integrity. Removal efficiency from 0.1 to 500 micron. Also available in black for UV curing systems.

SPECIFICATIONS

MATERIALS OF CONSTRUCTION:	Outer disc: Polypropylene Filter Media: Wide selection, see page 2 Media Supports: Depends on Filter Media O-Rings on quick fittings: Silicone, EPDM, NBR
FITTING CONNECTIONS:	See page 2
EFFECTIVE FILTRATION AREA:	15.9 cm ²
MAX. OPERATING TEMPERATURE:	80 °C
MAX. OPERATING CONDITIONS FOR LIQUIDS AT 22°C:	Operating Pressure: 5.5 bar
	Forward Differential Pressure: 2.1 bar
	Reverse Differential Pressure: 1.1 bar



PES MEMBRANE (S)	PTFE HYDROPHOBIC MEMBRANE (F)	GLASS FIBER (G)	HI PERFORMANCE PP MEDIA (HP)	PP MEDIA (P)	NYLON MEMBRANE (N)
020 = 0.2 µm	010 = 0.1 µm	H = HEPA	003 = 0.3 µm	006 = 0.6 µm	020 = 0.2 µm
045 = 0.45 µm	020 = 0.2 µm	002 = 0.2 µm	006 = 0.6 µm	010 = 1.0 µm	045 = 0.45 µm
065 = 0.65 µm	045 = 0.45 µm	004 = 0.45 µm	010 = 1.0 µm	030 = 3.0 µm	065 = 0.65 µm
080 = 0.8 µm	100 = 1.0 µm	005 = 0.5 µm	030 = 3.0 µm	050 = 5.0 µm	080 = 0.8 µm
120 = 1.2 µm	300 = 3.0 µm	010 = 1.0 µm	050 = 5.0 µm	070 = 7.0 µm	120 = 1.2 µm
	500 = 5.0 µm	030 = 3.0 µm	100 = 10 µm	100 = 10 µm	
	999 = 10 µm	050 = 5.0 µm		200 = 20 µm	
		100 = 10 µm		300 = 30 µm	
		200 = 20 µm		400 = 40 µm	
				500 = 50 µm	
				700 = 70 µm	

NYLON MELT-BLOWN (NN)	NYLON MESH (NS)	STAINLESS STEEL MESH (SS)	POLYPROPYLEN MESH (PS)
010 = 1 µm	070 = 7 µm	060 = 6 µm	10x = 100 µm
030 = 3 µm	100 = 10 µm	180 = 18 µm	15x = 150 µm
050 = 5 µm	200 = 20 µm	200 = 20 µm	20x = 200 µm
100 = 10 µm	400 = 40 µm	250 = 25 µm	30x = 300 µm
200 = 20 µm	600 = 60 µm	370 = 37 µm	50x = 500 µm
	10x = 100 µm	460 = 46 µm	
	20x = 200 µm	530 = 53 µm	
		610 = 61 µm	

FITTING GUIDE

1H
1/8" Hose barb

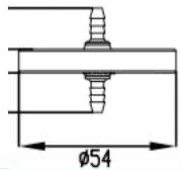

1N
1/8" NPTM

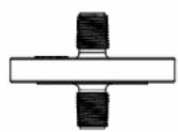

2H
1/4"-3/8" Hose barb

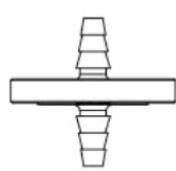

2N
1/4" NPTM

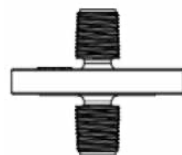

LM
Luer lock male

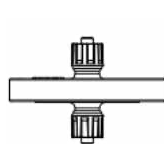

1NF
1/8" NPTF

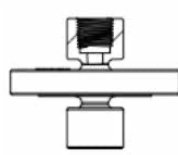

LF
Luer lock female

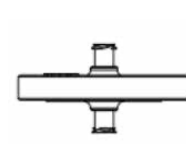

2C
1/4" Compression (JACO compatible)

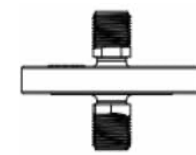

1Q
1/8" Male quick coupling (PMC/20-S)

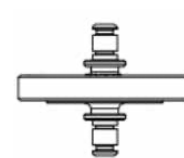

1QF
1/8" Female quick coupling (PMC/20-S)

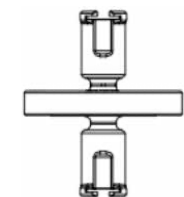

2Q
1/4" Male quick coupling (PLC/40-S)

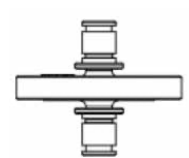

2NF
1/4" NPTF

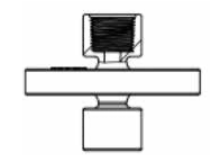

Data can change without prior notice. May 2025.